

# TWIN OAKS PLANTATION

1,913± TOTAL ACRES  
THOMASVILLE, GEORGIA

*This map is for visual aid only  
and the accuracy is not guaranteed.*



**Hall and Hall**  
Elliott Davenport, Jr. : (423) 362-2092

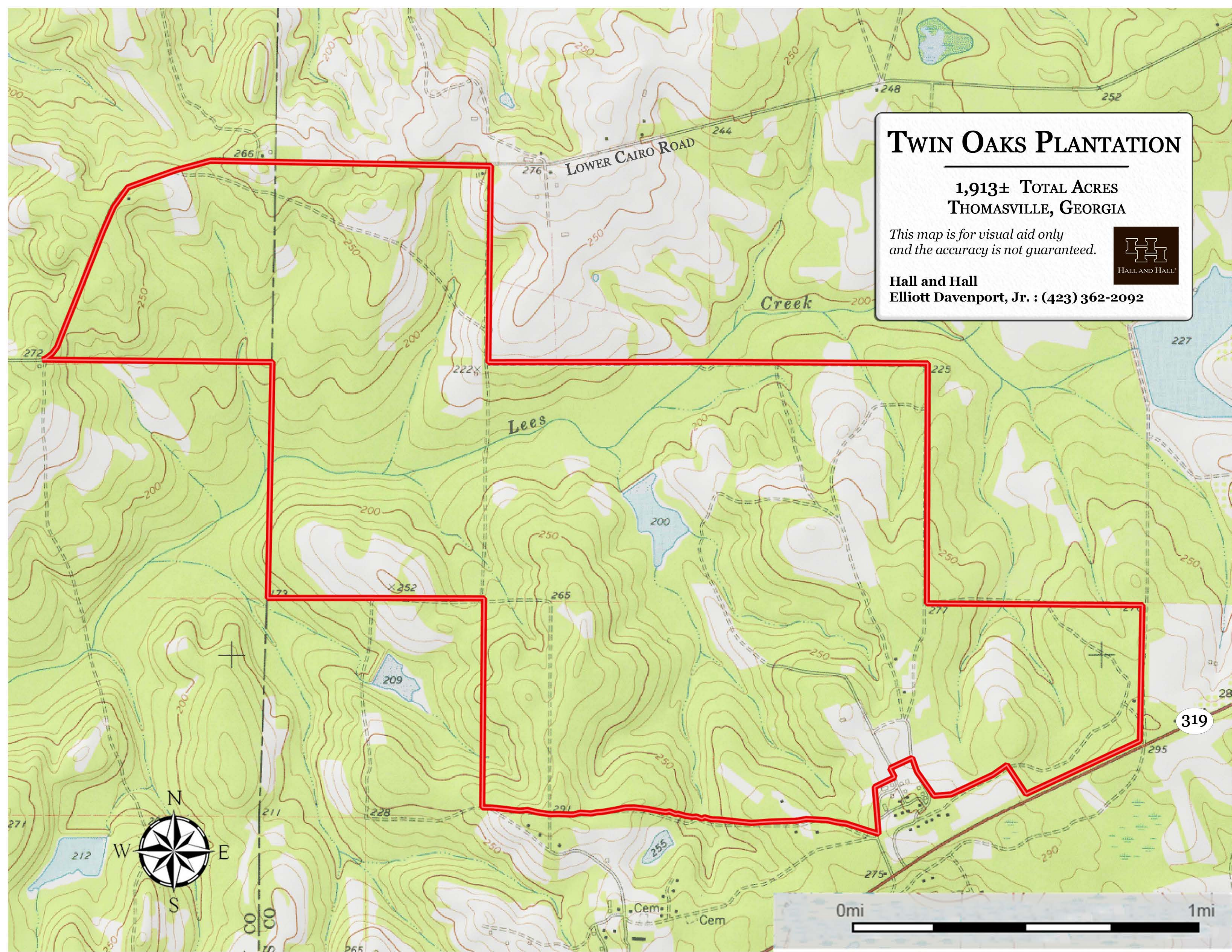



# TWIN OAKS PLANTATION

1,913± TOTAL ACRES  
THOMASVILLE, GEORGIA

*This map is for visual aid only  
and the accuracy is not guaranteed.*



**Hall and Hall**  
**Elliott Davenport, Jr. : (423) 362-2092**

SOIL CODE	SOIL DESCRIPTION	%
TsC2	Tifton sandy loam, 5 to 8 percent slopes, eroded	22.50%
TfB	Tifton loamy sand, 2 to 5 percent slopes	18.60%
Ap	Alapaha loamy sand	15.70%
DoB	Dothan loamy sand, 2 to 5 percent slopes	13.30%
FdC2	Faceville sandy loam, 5 to 8 percent slopes, eroded	4.90%
FsB	Fuquay loamy sand, 1 to 5 percent slopes	4.70%
OS	Osier and Pelham soils	3.40%
NcC	Nankin-Cowarts complex, 5 to 8 percent slopes	3.20%
FeB	Faceville sandy loam, 2 to 5 percent slopes	3.10%
FaB	Faceville loamy sand, 2 to 5 percent slopes	3%
Se	Stilson loamy sand	2.10%
OSA	Osier and Bibb soils, frequently flooded	1.40%
OsC2	Orangeburg sandy loam, 5 to 8 percent slopes, eroded	1.30%
W	Water	0.60%
PeA	Pelham loamy fine sand, frequently flooded	0.50%
LmC	Lucy loamy sand, 5 to 8 percent slopes	0.40%
CaC2	Carnegie sandy loam, 5 to 8 percent slopes, eroded	0.30%
NcD	Nankin-Cowarts complex, 8 to 12 percent slopes	0.30%
LmB	Lucy loamy sand, 0 to 5 percent slopes	0.30%
Le	Leefield loamy sand	0.20%
FaD	Faceville loamy sand, 8 to 12 percent slopes	0.20%
TfA	Tifton loamy sand, 0 to 2 percent slopes	0.10%
TfC	Tifton loamy sand, 5 to 8 percent slopes	0.10%
TrB	Troup loamy sand, 0 to 5 percent slopes	0.03%
BoB	Bonneau loamy sand, 0 to 5 percent slopes	0.01%

